

upper cabinets

Xpress

CEUCG

Upper Cabinet for Blind Corner – Glass Door

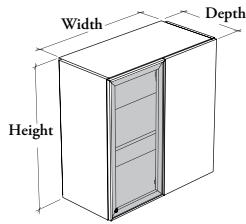

WHAT'S INCLUDED

1 upper cabinet, mounting hardware, locks and keys (as specified), 1 fixed panel and adjustable shelf(ves) listed below:

Adjustable Shelf(ves)	24" to 36" w
24" to 30" h (Shown)	1
33" to 42" h	2

WHAT'S EXCLUDED

Wall-Mounted Rail for Upper Cabinet (CEUR) and Recessed LED Light (CEALED).

NOTES

Light Management with Groove Connection (L or R) and Integrated End Panel **cannot** be specified on the Fixed Panel side.

An Integrated End Panel **cannot** be specified on the same side as a groove connection in the Light Management options.

When Flintwood Fixed Panel Finish is specified, only Not Applicable (NA) Edge Trim Finish is available.

The Fixed Panel is always half the width of the cabinet.

When a shelf is included, holes at 1 1/4" intervals allow for shelf adjustment.

Additional Shelves for Cabinet (CEACS) are available and must be specified separately.

Xpress See *Xpress Program* and/or specification software for finishes availability.

PRODUCT OPTIONS

Depth	Width	Height	Fixed Panel Position	Light Management	Integrated End Panel	Hinge Style
12, 15	24, 27, 30, 33, 36	24, 27, 30, 33, 36, 42	L Fixed Panel – Left R Fixed Panel – Right (Shown)	L Groove Connection – Left R Groove Connection – Right X Groove Connection – None N No Light Management	L End Panel – Left R End Panel – Right N End Panel – None (Shown)	S Standard – Soft Close

SAMPLE ORDER CODE

CEUCG 15	24	30	L	N	N	S
-----------------	-----------	-----------	----------	----------	----------	----------

PRODUCT OPTIONS CONTINUED

Fixed Panel Finish	Edge Trim Finish	Case Finish	Door Frame Finish	Glass Door Finish	Pull Style	Key Style
Source Laminate	Edge Trim Colors	Source Laminate	Foundation	Standard:	X Finger Pull	K Keyed Alike
Foundation Laminate	NA Not Applicable	Flintwood (No Cathedral)	Accent	CL Clear		R Keyed Randomly
Grade 2 Laminate			Mica	FT Frosted		N No Lock
Flintwood (No Cathedral)				Back-Painted		

SAMPLE ORDER CODE CONTINUED

3G	4G	3G	83	K7	X	N
-----------	-----------	-----------	-----------	-----------	----------	----------

See Pricing on the following page.

CEUCG

Upper Cabinet for Blind Corner – Glass Door (Continued)

DIMENSIONS
INCHES / MM

PRICING

KEY UPCHARGE

SOURCE LAMINATE FIXED PANEL			FOUNDATION LAMINATE FIXED PANEL		Keyed Alike or Keyed Randomly		
SOURCE LAMINATE CASE							
GLASS FINISH							
D	W	H	Clear (CL)	Frosted (FT) / Back-Painted	Clear (CL)	Frosted (FT) / Back-Painted	
12 / 305	24 / 610	24 / 610	1155	1164	1208	1217	28
12 / 305	24 / 610	27 / 686	1195	1204	1255	1264	28
12 / 305	24 / 610	30 / 762	1236	1244	1302	1310	28
12 / 305	24 / 610	33 / 838	1308	1319	1381	1392	28
12 / 305	24 / 610	36 / 914	1333	1347	1413	1427	28
12 / 305	24 / 610	42 / 1067	1413	1432	1505	1524	28
12 / 305	27 / 686	24 / 610	1194	1204	1253	1263	28
12 / 305	27 / 686	27 / 686	1237	1246	1304	1313	28
12 / 305	27 / 686	30 / 762	1282	1291	1356	1365	28
12 / 305	27 / 686	33 / 838	1360	1372	1442	1454	28
12 / 305	27 / 686	36 / 914	1390	1405	1480	1495	28
12 / 305	27 / 686	42 / 1067	1475	1496	1580	1601	28
12 / 305	30 / 762	24 / 610	1231	1241	1298	1308	28
12 / 305	30 / 762	27 / 686	1279	1289	1354	1364	28
12 / 305	30 / 762	30 / 762	1326	1336	1409	1419	28
12 / 305	30 / 762	33 / 838	1413	1426	1504	1517	28
12 / 305	30 / 762	36 / 914	1446	1462	1545	1561	28
12 / 305	30 / 762	42 / 1067	1539	1561	1655	1677	28
12 / 305	33 / 838	24 / 610	1270	1281	1343	1354	28
12 / 305	33 / 838	27 / 686	1321	1331	1403	1413	28
12 / 305	33 / 838	30 / 762	1372	1382	1463	1473	28
12 / 305	33 / 838	33 / 838	1465	1479	1565	1579	28
12 / 305	33 / 838	36 / 914	1503	1520	1612	1629	28
12 / 305	33 / 838	42 / 1067	1604	1628	1732	1756	28
12 / 305	36 / 914	24 / 610	1309	1320	1388	1399	28
12 / 305	36 / 914	27 / 686	1364	1375	1453	1464	28
12 / 305	36 / 914	30 / 762	1418	1429	1517	1528	28
12 / 305	36 / 914	33 / 838	1518	1533	1627	1642	28
12 / 305	36 / 914	36 / 914	1558	1576	1677	1695	28
12 / 305	36 / 914	42 / 1067	1667	1693	1806	1832	28
15 / 381	24 / 610	24 / 610	1215	1224	1268	1277	28
15 / 381	24 / 610	27 / 686	1259	1268	1319	1328	28
15 / 381	24 / 610	30 / 762	1304	1312	1370	1378	28
15 / 381	24 / 610	33 / 838	1388	1399	1461	1472	28
15 / 381	24 / 610	36 / 914	1431	1445	1511	1525	28
15 / 381	24 / 610	42 / 1067	1505	1524	1597	1616	28
15 / 381	27 / 686	24 / 610	1256	1266	1315	1325	28
15 / 381	27 / 686	27 / 686	1305	1314	1372	1381	28
15 / 381	27 / 686	30 / 762	1355	1364	1429	1438	28
15 / 381	27 / 686	33 / 838	1448	1460	1530	1542	28
15 / 381	27 / 686	36 / 914	1496	1511	1586	1601	28
15 / 381	27 / 686	42 / 1067	1579	1600	1684	1705	28

Pricing is continued on the following page.

upper cabinets

Xpress

CEUCG

Upper Cabinet for Blind Corner – Glass Door (Continued)

DIMENSIONS
INCHES / MM

PRICING

KEY
UPCHARGE

			SOURCE LAMINATE FIXED PANEL		FOUNDATION LAMINATE FIXED PANEL				Keyed Alike or Keyed Randomly		
			SOURCE LAMINATE CASE								
			GLASS FINISH								
D	W	H	Clear (CL)	Frosted (FT) / Back-Painted	Clear (CL)	Frosted (FT) / Back-Painted	Clear (CL)	Frosted (FT) / Back-Painted			
15 / 381	30 / 762	24 / 610	1296	1306	1363	1373			28		
15 / 381	30 / 762	27 / 686	1350	1360	1425	1435			28		
15 / 381	30 / 762	30 / 762	1404	1414	1487	1497			28		
15 / 381	30 / 762	33 / 838	1507	1520	1598	1611			28		
15 / 381	30 / 762	36 / 914	1560	1576	1659	1675			28		
15 / 381	30 / 762	42 / 1067	1653	1675	1769	1791			28		
15 / 381	33 / 838	24 / 610	1337	1348	1410	1421			28		
15 / 381	33 / 838	27 / 686	1396	1406	1478	1488			28		
15 / 381	33 / 838	30 / 762	1456	1466	1547	1557			28		
15 / 381	33 / 838	33 / 838	1566	1580	1666	1680			28		
15 / 381	33 / 838	36 / 914	1625	1642	1734	1751			28		
15 / 381	33 / 838	42 / 1067	1728	1752	1856	1880			28		
15 / 381	36 / 914	24 / 610	1377	1388	1456	1467			28		
15 / 381	36 / 914	27 / 686	1442	1453	1531	1542			28		
15 / 381	36 / 914	30 / 762	1505	1516	1604	1615			28		
15 / 381	36 / 914	33 / 838	1625	1640	1734	1749			28		
15 / 381	36 / 914	36 / 914	1688	1706	1807	1825			28		
15 / 381	36 / 914	42 / 1067	1803	1829	1942	1968			28		
			GRADE 2 LAMINATE FIXED PANEL		FLINTWOOD FIXED PANEL				Keyed Alike or Keyed Randomly		
			SOURCE LAMINATE CASE		FLINTWOOD CASE						
			GLASS FINISH								
D	W	H	Clear (CL)	Frosted (FT) / Back-Painted	Clear (CL)	Frosted (FT) / Back-Painted	Clear (CL)	Frosted (FT) / Back-Painted			
12 / 305	24 / 610	24 / 610	1263	1272	2458	2467	1259	1268	2454	2463	28
12 / 305	24 / 610	27 / 686	1316	1325	2575	2584	1308	1317	2567	2576	28
12 / 305	24 / 610	30 / 762	1370	1378	2693	2701	1357	1365	2680	2688	28
12 / 305	24 / 610	33 / 838	1456	1467	2806	2817	1437	1448	2787	2798	28
12 / 305	24 / 610	36 / 914	1495	1509	2918	2932	1471	1485	2894	2908	28
12 / 305	24 / 610	42 / 1067	1601	1620	3142	3161	1567	1586	3108	3127	28
12 / 305	27 / 686	24 / 610	1315	1325	2583	2593	1304	1314	2572	2582	28
12 / 305	27 / 686	27 / 686	1374	1383	2708	2717	1357	1366	2691	2700	28
12 / 305	27 / 686	30 / 762	1433	1442	2832	2841	1411	1420	2810	2819	28
12 / 305	27 / 686	33 / 838	1527	1539	2952	2964	1500	1512	2925	2937	28
12 / 305	27 / 686	36 / 914	1572	1587	3071	3086	1539	1554	3038	3053	28
12 / 305	27 / 686	42 / 1067	1687	1708	3308	3329	1644	1665	3265	3286	28
12 / 305	30 / 762	24 / 610	1366	1376	2709	2719	1347	1357	2690	2700	28
12 / 305	30 / 762	27 / 686	1431	1441	2841	2851	1406	1416	2816	2826	28
12 / 305	30 / 762	30 / 762	1494	1504	2971	2981	1464	1474	2941	2951	28
12 / 305	30 / 762	33 / 838	1598	1611	3098	3111	1562	1575	3062	3075	28
12 / 305	30 / 762	36 / 914	1648	1664	3224	3240	1606	1622	3182	3198	28
12 / 305	30 / 762	42 / 1067	1775	1797	3476	3498	1722	1744	3423	3445	28

Pricing is continued on the following page.

CEUCG

Upper Cabinet for Blind Corner – Glass Door (Continued)

DIMENSIONS
INCHES / MM

PRICING

KEY
UPCHARGE

			GRADE 2 LAMINATE FIXED PANEL				FLINTWOOD FIXED PANEL				KEYED ALIKE OR KEYED RANDOMLY
			SOURCE LAMINATE CASE		FLINTWOOD CASE		SOURCE LAMINATE CASE		FLINTWOOD CASE		
			GLASS FINISH								
D	W	H	Clear (CL)	Frosted (FT)/ Back-Painted	Clear (CL)	Frosted (FT)/ Back-Painted	Clear (CL)	Frosted (FT)/ Back-Painted	Clear (CL)	Frosted (FT)/ Back-Painted	
12 / 305	33 / 838	24 / 610	1418	1429	2833	2844	1392	1403	2807	2818	28
12 / 305	33 / 838	27 / 686	1487	1497	2971	2981	1455	1465	2939	2949	28
12 / 305	33 / 838	30 / 762	1557	1567	3110	3120	1519	1529	3072	3082	28
12 / 305	33 / 838	33 / 838	1669	1683	3243	3257	1625	1639	3199	3213	28
12 / 305	33 / 838	36 / 914	1725	1742	3377	3394	1675	1692	3327	3344	28
12 / 305	33 / 838	42 / 1067	1863	1887	3643	3667	1801	1825	3581	3605	28
12 / 305	36 / 914	24 / 610	1470	1481	2959	2970	1437	1448	2926	2937	28
12 / 305	36 / 914	27 / 686	1545	1556	3104	3115	1505	1516	3064	3075	28
12 / 305	36 / 914	30 / 762	1620	1631	3250	3261	1574	1585	3204	3215	28
12 / 305	36 / 914	33 / 838	1740	1755	3390	3405	1688	1703	3338	3353	28
12 / 305	36 / 914	36 / 914	1800	1818	3530	3548	1742	1760	3472	3490	28
12 / 305	36 / 914	42 / 1067	1950	1976	3812	3838	1878	1904	3740	3766	28
15 / 381	24 / 610	24 / 610	1323	1332	2552	2561	1319	1328	2548	2557	28
15 / 381	24 / 610	27 / 686	1380	1389	2677	2686	1372	1381	2669	2678	28
15 / 381	24 / 610	30 / 762	1438	1446	2802	2810	1425	1433	2789	2797	28
15 / 381	24 / 610	33 / 838	1536	1547	2923	2934	1517	1528	2904	2915	28
15 / 381	24 / 610	36 / 914	1593	1607	3043	3057	1569	1583	3019	3033	28
15 / 381	24 / 610	42 / 1067	1693	1712	3282	3301	1659	1678	3248	3267	28
15 / 381	27 / 686	24 / 610	1377	1387	2681	2691	1366	1376	2670	2680	28
15 / 381	27 / 686	27 / 686	1442	1451	2815	2824	1425	1434	2798	2807	28
15 / 381	27 / 686	30 / 762	1506	1515	2949	2958	1484	1493	2927	2936	28
15 / 381	27 / 686	33 / 838	1615	1627	3077	3089	1588	1600	3050	3062	28
15 / 381	27 / 686	36 / 914	1678	1693	3205	3220	1645	1660	3172	3187	28
15 / 381	27 / 686	42 / 1067	1791	1812	3461	3482	1748	1769	3418	3439	28
15 / 381	30 / 762	24 / 610	1431	1441	2812	2822	1412	1422	2793	2803	28
15 / 381	30 / 762	27 / 686	1502	1512	2954	2964	1477	1487	2929	2939	28
15 / 381	30 / 762	30 / 762	1572	1582	3094	3104	1542	1552	3064	3074	28
15 / 381	30 / 762	33 / 838	1692	1705	3231	3244	1656	1669	3195	3208	28
15 / 381	30 / 762	36 / 914	1762	1778	3368	3384	1720	1736	3326	3342	28
15 / 381	30 / 762	42 / 1067	1889	1911	3640	3662	1836	1858	3587	3609	28
15 / 381	33 / 838	24 / 610	1485	1496	2942	2953	1459	1470	2916	2927	28
15 / 381	33 / 838	27 / 686	1562	1572	3091	3101	1530	1540	3059	3069	28
15 / 381	33 / 838	30 / 762	1641	1651	3242	3252	1603	1613	3204	3214	28
15 / 381	33 / 838	33 / 838	1770	1784	3385	3399	1726	1740	3341	3355	28
15 / 381	33 / 838	36 / 914	1847	1864	3530	3547	1797	1814	3480	3497	28
15 / 381	33 / 838	42 / 1067	1987	2011	3818	3842	1925	1949	3756	3780	28
15 / 381	36 / 914	24 / 610	1538	1549	3072	3083	1505	1516	3039	3050	28
15 / 381	36 / 914	27 / 686	1623	1634	3230	3241	1583	1594	3190	3201	28
15 / 381	36 / 914	30 / 762	1707	1718	3387	3398	1661	1672	3341	3352	28
15 / 381	36 / 914	33 / 838	1847	1862	3540	3555	1795	1810	3488	3503	28
15 / 381	36 / 914	36 / 914	1930	1948	3691	3709	1872	1890	3633	3651	28
15 / 381	36 / 914	42 / 1067	2086	2112	3998	4024	2014	2040	3926	3952	28