

# storage cabinets

**Xpress**

## CETO

### Tall Cabinet – Open

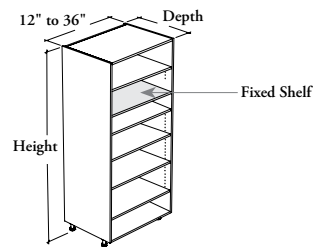

#### WHAT'S INCLUDED

1 tall cabinet, adjustable feet, clips for toe kick – front, mounting hardware, 1 fixed shelf and adjustable shelves as listed below:

Adjustable Shelves	72" to 84" h	90" to 96" h
	5	6

#### WHAT'S EXCLUDED

Toe Kick – Front (CEATF) and Toe Kick – Side (CEATS).

#### NOTES

Holes at 1 1/4" intervals allow for shelf adjustment.

Additional Shelves for Cabinet (CEACS) are available and must be specified separately.

**Xpress** See *Xpress Program* and/or specification software for finishes availability.

#### PRODUCT OPTIONS

Depth	Width	Height	Case Finish
24	12, 15, 18, 21, 24, 27, 30, 33, 36	72, 84, 90, 96	Source Laminate Flintwood (No Cathedral)

#### SAMPLE ORDER CODE

<b>CETO 24</b>	<b>24</b>	<b>84</b>	<b>3F</b>
----------------	-----------	-----------	-----------

#### DIMENSIONS INCHES / MM

D	W	H
24 / 610	12 / 305	72 / 1829
24 / 610	15 / 381	72 / 1829
24 / 610	18 / 457	72 / 1829
24 / 610	21 / 533	72 / 1829
24 / 610	24 / 610	72 / 1829
24 / 610	27 / 686	72 / 1829
24 / 610	30 / 762	72 / 1829
24 / 610	33 / 838	72 / 1829
24 / 610	36 / 914	72 / 1829
24 / 610	12 / 305	84 / 2134
24 / 610	15 / 381	84 / 2134
24 / 610	18 / 457	84 / 2134
24 / 610	21 / 533	84 / 2134
24 / 610	24 / 610	84 / 2134
24 / 610	27 / 686	84 / 2134
24 / 610	30 / 762	84 / 2134
24 / 610	33 / 838	84 / 2134
24 / 610	36 / 914	84 / 2134

#### PRICING

CASE FINISH	
Source Laminate	Flintwood
1178	3812
1263	4015
1349	4218
1435	4421
1523	4629
1607	4837
1687	5045
1770	5253
1854	5456
1258	4011
1343	4221
1429	4431
1515	4641
1603	4858
1687	5074
1767	5291
1850	5508
1934	5720

Pricing is continued on the following page.

**C E B O**  
**Base Cabinet – Open (Continued)**

**DIMENSIONS**  
**INCHES / MM**

D	W	H
24 / 610	12 / 305	90 / 2286
24 / 610	15 / 381	90 / 2286
24 / 610	18 / 457	90 / 2286
24 / 610	21 / 533	90 / 2286
24 / 610	24 / 610	90 / 2286
24 / 610	27 / 686	90 / 2286
24 / 610	30 / 762	90 / 2286
24 / 610	33 / 838	90 / 2286
24 / 610	36 / 914	90 / 2286
24 / 610	12 / 305	96 / 2438
24 / 610	15 / 381	96 / 2438
24 / 610	18 / 457	96 / 2438
24 / 610	21 / 533	96 / 2438
24 / 610	24 / 610	96 / 2438
24 / 610	27 / 686	96 / 2438
24 / 610	30 / 762	96 / 2438
24 / 610	33 / 838	96 / 2438
24 / 610	36 / 914	96 / 2438

**PRICING**

CASE FINISH	
Source Laminate	Flintwood
1337	4270
1429	4502
1522	4733
1615	4965
1710	5202
1801	5442
1887	5683
1977	5923
2068	6157
1377	4369
1472	4605
1568	4840
1664	5076
1762	5316
1859	5560
1950	5806
2046	6050
2143	6290