

# base cabinets

**Xpress**

## CEBKFS

### Base Cabinet for Sink – Doors and False Front

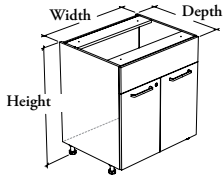

#### WHAT'S INCLUDED

1 base cabinet, adjustable feet, clips for toe kick – front, pulls (as specified), locks and keys (as specified) and mounting hardware.

#### WHAT'S EXCLUDED

Countertop (CEWCT), Toe Kick – Front (CEATF) and Toe Kick – Side (CEATS).

#### NOTES

When planning for people with reduced mobility, Base Cabinets for Sink (CEBKRS and CEBKRO) should be specified instead of this product.

Sink Cut-Out must be done by installer.

No shelf included.

When Flintwood Front Finish is specified, only Not Applicable (NA) Edge Trim Finish is available.

When Stainless (8) or Drilled On-Site – No Pull (Z) Pull Style is specified, Pull Finish is **not** available.

Additional Shelves for Cabinet (CEACS) **cannot** be specified with this product.

**Xpress** See *Xpress Program* and/or specification software for finishes availability.

#### PRODUCT OPTIONS

Depth	Width	Height	Hinge Style	Front Finish
24, 29	24, 27, 30, 33, 36, 42	32, 35	<b>F</b> Full Extension – Soft Close <b>S</b> Standard – Soft Close	Source Laminate Foundation Laminate Grade 2 Laminate Flintwood (No Cathedral)

#### SAMPLE ORDER CODE

<b>CEBKFS 24</b>	<b>30</b>	<b>35</b>	<b>F</b>	<b>3G</b>
------------------	-----------	-----------	----------	-----------

#### PRODUCT OPTIONS CONTINUED

Edge Trim Finish	Case Finish	Pull Style		Pull Finish (If Applicable)	Key Style
Edge Trim Colors <b>NA</b> Not Applicable	Source Laminate	<b>1</b> Standard Expansion <b>8</b> Stainless (ADA) <b>9</b> Rectangular <b>E</b> Edge – Standard	<b>F</b> Edge – Small <b>M</b> Modern Straight (ADA) <b>S</b> Slim (Shown) <b>Z</b> Drilled On-Site – No Pull	Foundation Accent Mica	<b>K</b> Keyed Alike <b>R</b> Keyed Randomly <b>N</b> No Lock

#### SAMPLE ORDER CODE CONTINUED

<b>4G</b>	<b>3G</b>	<b>S</b>	<b>52</b>	<b>N</b>
-----------	-----------	----------	-----------	----------

See Pricing on the following page.

**C E B K F S**  
**Base Cabinet for Sink – Doors and**  
**False Front (Continued)**

**DIMENSIONS**  
**INCHES / MM**

D	W	H
24 / 610	24 / 610	32 / 813
24 / 610	27 / 686	32 / 813
24 / 610	30 / 762	32 / 813
24 / 610	33 / 838	32 / 813
24 / 610	36 / 914	32 / 813
24 / 610	42 / 1067	32 / 813
24 / 610	24 / 610	35 / 889
24 / 610	27 / 686	35 / 889
24 / 610	30 / 762	35 / 889
24 / 610	33 / 838	35 / 889
24 / 610	36 / 914	35 / 889
24 / 610	42 / 1067	35 / 889
29 / 737	24 / 610	32 / 813
29 / 737	27 / 686	32 / 813
29 / 737	30 / 762	32 / 813
29 / 737	33 / 838	32 / 813
29 / 737	36 / 914	32 / 813
29 / 737	42 / 1067	32 / 813
29 / 737	24 / 610	35 / 889
29 / 737	27 / 686	35 / 889
29 / 737	30 / 762	35 / 889
29 / 737	33 / 838	35 / 889
29 / 737	36 / 914	35 / 889
29 / 737	42 / 1067	35 / 889

**PRICING**

STANDARD – SOFT CLOSE HINGE (S)				FULL EXTENSION – SOFT CLOSE HINGE (F)			
FRONT FINISH							
Source Laminate	Foundation Laminate	Grade 2 Laminate	Flintwood	Source Laminate	Foundation Laminate	Grade 2 Laminate	Flintwood
981	1105	1232	1568	1053	1177	1304	1640
1031	1170	1314	1630	1103	1242	1386	1702
1079	1234	1393	1691	1151	1306	1465	1763
1129	1299	1474	1754	1201	1371	1546	1826
1177	1362	1554	1816	1249	1434	1626	1888
1276	1492	1715	1940	1348	1564	1787	2012
1013	1150	1291	1607	1085	1222	1363	1679
1068	1222	1381	1672	1140	1294	1453	1744
1122	1293	1470	1735	1194	1365	1542	1807
1177	1365	1559	1800	1249	1437	1631	1872
1230	1435	1647	1864	1302	1507	1719	1936
1339	1578	1825	1993	1411	1650	1897	2065
1019	1143	1270	1606	1091	1215	1342	1678
1072	1211	1355	1671	1144	1283	1427	1743
1124	1279	1438	1736	1196	1351	1510	1808
1177	1347	1522	1802	1249	1419	1594	1874
1229	1414	1606	1868	1301	1486	1678	1940
1336	1552	1775	2000	1408	1624	1847	2072
1062	1199	1340	1656	1134	1271	1412	1728
1120	1274	1433	1724	1192	1346	1505	1796
1178	1349	1526	1791	1250	1421	1598	1863
1236	1424	1618	1859	1308	1496	1690	1931
1292	1497	1709	1926	1364	1569	1781	1998
1408	1647	1894	2062	1480	1719	1966	2134