

# base cabinets

**Xpress**

## C E B C A S

### Base Cabinet for Standard Corner – Door

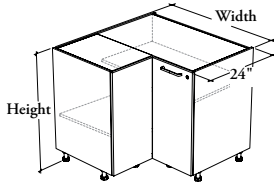

#### WHAT'S INCLUDED

1 base cabinet, adjustable feet, clips for toe kick – front, pull (as specified), mounting hardware, locks and keys (as specified), and 2 adjustable shelves.

#### WHAT'S EXCLUDED

Countertop (CEWCT), Toe Kick – Front (CEATF) and Toe Kick – Side (CEATS).

#### NOTES

32" high cabinet is suitable for People with Reduced Mobility.

When Flintwood Front Finish is specified, only Not Applicable (NA) Edge Trim Finish is available.

When Stainless (8) or Drilled On-Site – No Pull (Z) Pull Style is specified, Pull Finish is **not** available.

Shelves are always 24" deep.

Holes at 1 1/4" intervals allow for shelf adjustment.

Additional Shelves for Cabinet **cannot** be specified with this product.

**Xpress** See *Xpress Program* and/or specification software for finishes availability.

#### PRODUCT OPTIONS

Depth	Width	Height	Door Swing Direction	Hinge Style	Front Finish
24	36, 39	32, 35	<b>L</b> Door Swing – Left (Shown) <b>R</b> Door Swing – Right	<b>D</b> Standard	Source Laminate Foundation Laminate Grade 2 Laminate Flintwood (No Cathedral)

#### SAMPLE ORDER CODE

<b>CEBCAS 24</b>	<b>36</b>	<b>35</b>	<b>L</b>	<b>D</b>	<b>3G</b>
------------------	-----------	-----------	----------	----------	-----------

#### PRODUCT OPTIONS CONTINUED

Edge Trim Finish	Case Finish	Pull Style		Pull Finish (If Applicable)	Key Style
Edge Trim Colors <b>NA</b> Not Applicable	Source Laminate	<b>1</b> Standard Expansion <b>8</b> Stainless (ADA) <b>9</b> Rectangular <b>E</b> Edge – Standard	<b>F</b> Edge – Small <b>M</b> Modern Straight (ADA) <b>S</b> Slim (Shown) <b>Z</b> Drilled On-Site – No Pull	Foundation Accent Mica	<b>K</b> Keyed Alike <b>R</b> Keyed Randomly <b>N</b> No Lock

#### SAMPLE ORDER CODE CONTINUED

<b>4G</b>	<b>3G</b>	<b>S</b>	<b>52</b>	<b>N</b>
-----------	-----------	----------	-----------	----------

See Pricing on the following page.

**C E B C A S**  
**Base Cabinet for Standard Corner –**  
**Door (Continued)**

**DIMENSIONS**  
**INCHES / MM**

D	W	H
24 / 610	36 / 914	32 / 813
24 / 610	39 / 991	32 / 813
24 / 610	36 / 914	35 / 889
24 / 610	39 / 991	35 / 889

**PRICING**

LEFT (L) OR RIGHT DOOR SWING				
FRONT FINISH				
	Source Laminate	Foundation Laminate	Grade 2 Laminate	Flintwood
	1828	2013	2205	2243
	1944	2145	2352	2387
	1835	2040	2252	2257
	1951	2173	2403	2406