

finishing components

Xpress

CEAFSU

Side Filler – Upper Cabinet

WHAT'S INCLUDED

1 filler panel and mounting hardware.

NOTES

Side Filler can be installed to either match the case or the front of cabinet.

When Flintwood Side Filler Finish is specified, only Not Applicable (NA) Edge Trim Finish is available.

Compatible with all Upper Cabinets.

Xpress See *Xpress Program* and/or specification software for finishes availability.

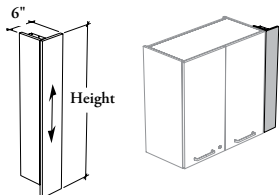

PRODUCT OPTIONS

Width	Height	Side Filler Finish	Edge Trim Finish
06	15, 24, 27, 30, 33, 36, 39, 42, 45, 51	Source Laminate Foundation Laminate Grade 2 Laminate Flintwood (No Cathedral)	Edge Trim Colors NA Not Applicable

SAMPLE ORDER CODE

CEAFSU 06	30	XG	SS
------------------	-----------	-----------	-----------

DIMENSIONS INCHES / MM

W	H
6 / 152	15 / 381
6 / 152	24 / 610
6 / 152	27 / 686
6 / 152	30 / 762
6 / 152	33 / 838
6 / 152	36 / 914
6 / 152	39 / 991
6 / 152	42 / 1067
6 / 152	45 / 1143
6 / 152	51 / 1295

PRICING

SIDE FILLER FINISH

Source Laminate	Foundation Laminate	Grade 2 Laminate	Flintwood
230	247	264	342
244	271	298	419
249	279	310	445
254	288	322	470
259	296	333	496
264	304	345	521
268	311	356	547
273	320	368	572
278	328	379	598
287	344	402	649