



C E A F S B

Side Filler – Base and Tall Cabinets

WHAT'S INCLUDED

1 filler panel and mounting hardware.

NOTES

Side Filler can be installed to either match the case or the front of cabinet.

When Flintwood Side Filler Finish is specified, only Not Applicable (NA) Edge Trim Finish is available.

Compatible with all Base Cabinets and all Tall Cabinets.

Xpress See *Xpress Program* and/or specification software for finishes availability.

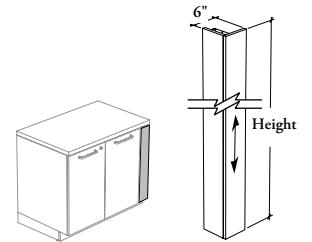

PRODUCT OPTIONS

Width	Height	Side Filler Finish	Edge Trim Finish
06	32, 35, 72, 84, 90, 96	Source Laminate Foundation Laminate Grade 2 Laminate Flintwood (No Cathedral)	Edge Trim Colors NA Not Applicable

SAMPLE ORDER CODE

CEAFSB 06	84	XG	SS
------------------	-----------	-----------	-----------

**DIMENSIONS
INCHES / MM**

W	H
6 / 152	32 / 813
6 / 152	35 / 889
6 / 152	72 / 1829
6 / 152	84 / 2134
6 / 152	90 / 2286
6 / 152	96 / 2438

PRICING

SIDE FILLER FINISH				
Source Laminate	Foundation Laminate	Grade 2 Laminate	Flintwood	
257	293	329	561	
262	301	341	573	
330	410	492	721	
351	444	540	769	
362	462	564	793	
373	479	588	817	